

LINN COUNTY STREET MAP

WITH FIRE DEPT. DISTRICTS

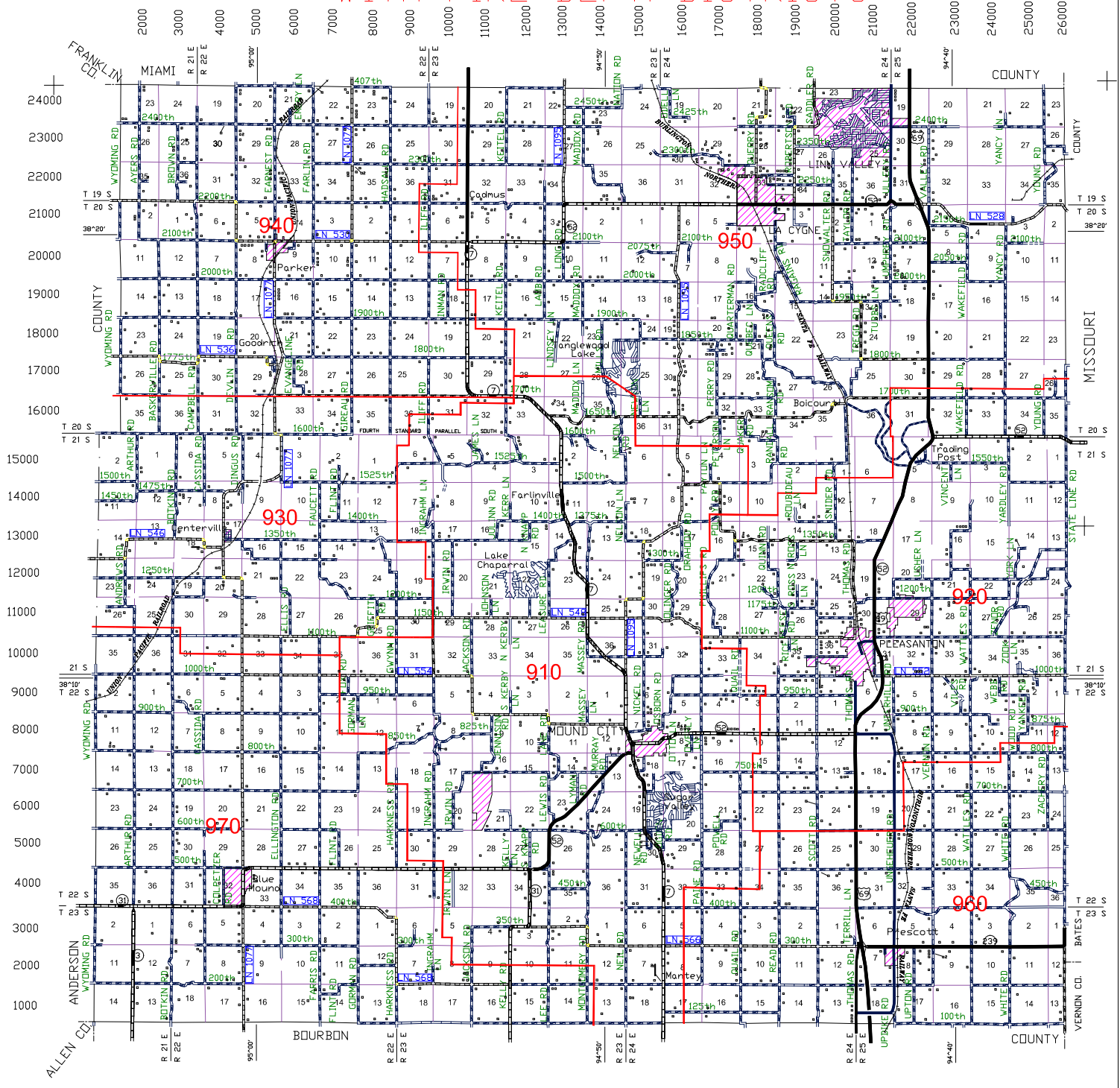

TOWNSHIP LOCATOR

| | | | | | |
|--------|--------|--------|--------|--------|--------|
| | R 21 E | R 22 E | R 23 E | R 24 E | R 25 E |
| T 19 S | 05 | 04 | 03 | 02 | 01 |
| T 20 S | 06 | 07 | 08 | 09 | 10 |
| T 21 S | 15 | 14 | 13 | 12 | 11 |
| T 22 S | 16 | 17 | 18 | 19 | 20 |
| T 23 S | 25 | 24 | 23 | 22 | 21 |

LEGEND

- WATER
- INTERSTATE HIGHWAY
- U.S. HIGHWAY
- STATE HIGHWAY
- COUNTY HIGHWAY
- ROADS, STREETS, CHURCHES, ETC. BY NAME
- SECTION CORNERS

ROADS AND ROADWAY FEATURES

- Primitive Road (Type A)
- Unimproved Road (Type B)
- Graded and Drained Road (Type C)
- Soil Surfaced Road (Type D)
- Gravel or Stone Road
- Bituminous Road Type (Type F, G, L)
- Paved Road (Type G-2, H-2, L, J, K)
- Divided Highway
- Highway With Full Control of Access
- Side Roads and Streets in Unincorporated Places
- 4 Lane Undivided Highway
- Projected Road

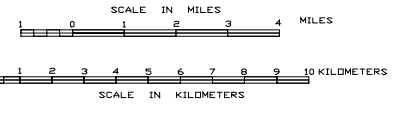

DRAWN BY LINN COUNTY MAPPING DEPT.
 BASED ON VARIOUS INFORMATION SOURCES
 DATE DRAWN: APRIL 5, 1999